



TMOUNT TABLE TENNIS



Taek-Soo Kim  
Korean National Men's team coach

**KIM TAEK SOO**  
**RELIVE THE LEGEND.**



**.TLAB**  
TMOUNT | R&D Center



## TMOUNT, A New Challenge and Beginning!

TMOUNT Co., Ltd. was established in 2015 based on accumulated knowledge in the basic material industry such as wood material, coating material, and high-polymer resin, and experience in developing table tennis products. The company has a professional workforce and the latest facilities for manufacturing table tennis tables and blades. It is recognized for product quality in the co-development of rubber with overseas companies.

### Main Performance of TMOUNT

TMOUNT products, recognized for quality in China and Japan;  
South Korea's only table tennis top manufacturer

- Registered for a patent, certificate, the LPM coating technique
- ISO 9001 Certificate for Quality Management System
- OEM manufacturing of table tennis tables with Butterfly, the world's largest table tennis brand
- Export contract for table tennis tables with 729, one of the 3 major table tennis brands in China
- Designated as an excellent sports equipment manufacturer by the the Ministry of Culture, Sports and Tourism
- Signed contract with E-mart, the largest retailer in South Korea
- Hosted common booth with the "729" company in the Sports Fair in Shanghai, China and ISPO Sport Fair in Germany
- Certificate of ITTF (International Table Tennis Foundation) for table tennis tables and products
- 2-year delivery of table tennis tables to Latin America Youth Olympics
- Domestic manufacturing and launching for premium blades
- Export contract for table tennis tables with Nittaku, one of the 3 major table tennis brands in Japan
- Delivered 1,000 table tennis tables to the Tianjin Sports event, the largest scale of its kind in China
- Brand launched by Taek-Soo Kim, coach to Mirae Asset Daewoo table tennis team, and coach of the male table tennis national team
- First material brand partner with Swarovski for manufacturing table tennis products

### Major Manufacturing Process of ECOTOP Table Tennis Table

As a solely domestic company specializing in manufacturing table tennis table top, its purpose is to produce high-quality table tennis tables based on an efficient work system.

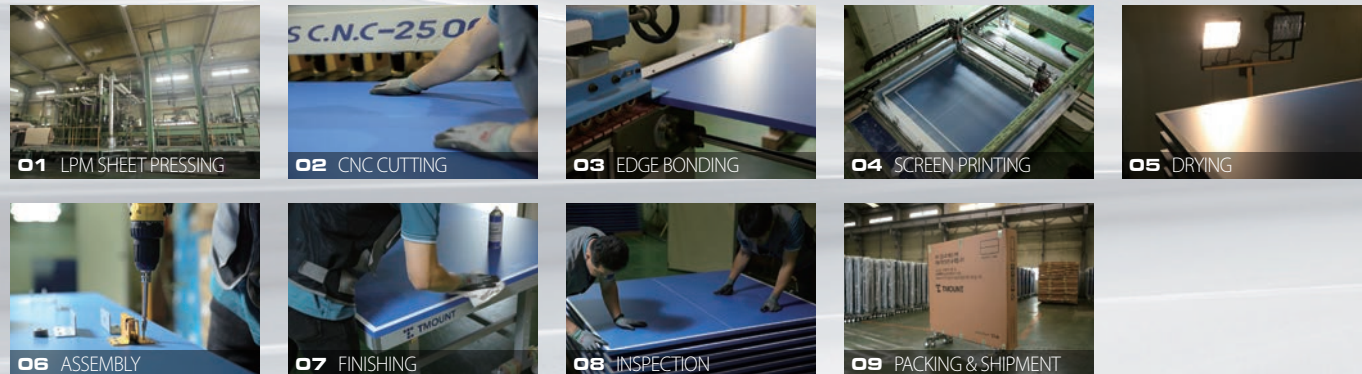

### Main Manufacturing Process of TCORE Blades

The TCORE blades of TMOUNT prioritizes optimized configuration and balance.  
The company produces high-quality products by undergoing detailed wood selection and test procedures by professional players.

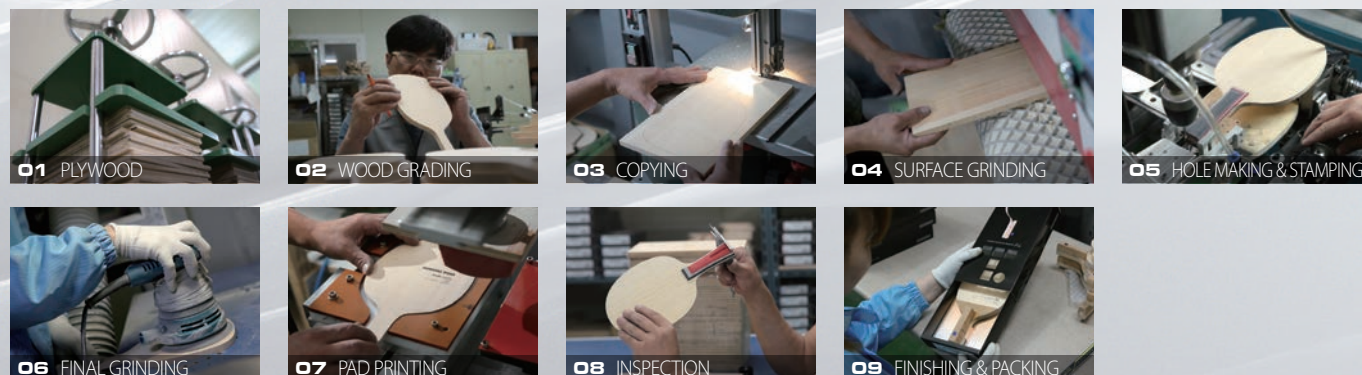

**TCORE MASTER X highly recommended by Taek-soo Kim,  
Korean national Men's team coach**

“It makes a really nasty ball and amazing trajectory”.

**APPROVED & TESTED BY KIM TAEK SOO  
AND PROFESSIONAL PLAYERS**



#### TCORE MASTER X

Color RED, BLACK | Hardness 53° | Thickness 2.1mm | Type Pimple in

Very aggressive rubber with extremely strong spin, catapult effect and clear sounds along with hard sponge. Experience the amazing catapult effect and nasty ball at the moment of impact  
Recommended to players mastering intermediate level skills.

MADE IN CHINA

USD 63.00





TCORE ACE 1 MAXSPEED

Color RED, BLACK | Hardness 50° | Thickness 2.1mm | Type Pimple in

High-tension rubber with excellent ball grip and long distance  
New standard of rubber combining technology of 3 countries: Korea, China, and Germany  
Optimal product available for use by different levels with excellent stability and usability



MADE IN CHINA

USD 49.50



TCORE ACE 1 MAXSPEED

Color RED, BLACK | Hardness 50° | Thickness 2.1mm | Type Pimple in

Aggressive rubber with high-tension top sheet and hard sponge focusing on spin  
New standard of rubber combining technology of 3 countries: Korea, China, and Germany  
Recommended to players mastering intermediate level skills



MADE IN CHINA

USD 49.50



TCORE ACE 2 MAXSPIN

Color RED, BLACK | Hardness 47.5° | Thickness 2.1mm | Type Pimple in

A strong attack rubber with stable and accurate ball control  
New standard of rubber combining technology of 3 countries: Korea, China, and Germany  
Optimal product where various skills can be implemented by reducing attack mistakes with accurate control



MADE IN CHINA

USD 49.50

TCORE ACE Series  
Approved & tested by Kim Taek Soo and professional players

TCORE ACE Series is a new standard rubber that combined the best manufacturing technology from Korea, China and Germany. TLAB(Table Tennis R&D Institute) has analyzed a big data specifically on players' preference, inclination and performance test to achieve a perfect product and a new paradigm. Based on TLAB's big data, we have combined the world-class German elastomer sponge and special coating foaming technology. We achieved a terrific synergy by collaborating with a company that has a long history of manufacturing over 45 years and a cutting-edge double-layer technology.



PRESTO SPIN

Color RED, BLACK | Hardness 47.5° | Thickness 2.1mm | Type Pimple in

The rubber is specially designed for purpose of increasing attacking spinning strong spin and arc down with the high tension topsheet



MADE IN CHINA

N/A



PRESTO SPEED

Color RED, BLACK | Hardness 47.5° | Thickness 2.1mm | Type Pimple in

The rubber is specially designed for purpose of increasing attacking speed fast attacking speed and long arc with the high tension topsheet



MADE IN CHINA

N/A



DERWIND RAYHE

Color RED, BLACK | Hardness 45°, 47.5° | Thickness 2.1mm | Type Pimple in

The new developed large pores sponge is used with BIOS rubber that is suitable for forehand players suitable for the players who have expansive movements and sufficient strength



MADE IN GERMANY

N/A



DERWIND STELLAR

Color RED, BLACK | Hardness 47.5° | Thickness 2.1mm | Type Pimple in

High-tension and excellent control using elastomer sponge from Germany  
Equipped with special forming technology for extremely strong performance with 40+ ABS ball  
High-tension rubber for top-spin attack and various skills with high accuracy



MADE IN GERMANY

USD 49.50



## TMOUNT X Taek-Soo Kim

### Coach Taek-Soo Kim, the world-class legend of all time for penholder

He is the legendary player leading table tennis in Korea with his fantastic footwork, strong forehand, drive, and counter-attack with penholder, remaining as one of the top 10 world-class players of all time for 10 years with top-class performance.

- Current coach of the male table tennis national team; coach of Mirae Asset Daewoo table tennis team
- No. 1 Penholder player in the 20th century
- Textbook demonstration of penholder player
- Miraculous 32-ball rally with Liu Guoliang
- Top 10 world-class
- Grand slam in All-Star Circuit
- National table tennis player for 17 years
- Miraculous footwork play



#### KTS PENHOLDER SERIES,

the premium brand co-developed with coach Taek-Soo Kim, the penholder legend

The KTS penholder series has focused on the selection of material, which is the core element in the blades. Based on refined design and precise processing technology, it will be establishing a new standard for a premium penholder.

#### KISO HINOKI - Selection of wood material is more important.

The core element of the KTS penholder series starts from selection of premium wood material. Kiso Hinoki grows very slowly, which makes its wood quality very solid and thick. As the age is older and there are no knots in Kiso Hinoki, quarter sawing is meticulous and uniform, and bending and deformation is low. By undergoing selection of Hinoki 3 times, Kiso Hinoki is categorized in each grade depending on soft resounding and hitting sensitivity. It is then made into the complete product by undergoing final inspection and approval by coach Taek-Soo Kim.

## KTS PENHOLDER SERIES

the premium brand co-developed with coach Taek-Soo Kim, the penholder legend

- Collaboration between coach Taek-Soo Kim, a legendary penholder player, and TMOUNT, a company recognized for top quality
- Commercialization after final approval by coach Taek-Soo Kim
- Penholder power fueled by premium mono-ply, 10.5mm thickness Kiso Hinoki
- Kiso Hinoki performance is maximized with selective wood and 3D touch precision processing
- Guaranteed reliable manufacturing management and excellent quality based on manufacturing made in Korea



#### KIM TAEK SOO THE LIMITED EDITION

Blade Size W255 × 134mm | Head Size W145 × 134mm  
Thickness Kiso Hinoki 10.5mm



MADE IN KOREA

USD 900.00



#### KIM TAEK SOO THE SIGNATURE

Blade Size W255 × 134mm | Head Size W145 × 134mm  
Thickness Kiso Hinoki 10.5mm



MADE IN KOREA

USD 495.00



#### KIM TAEK SOO PRIME X

Blade Size W255 × 134mm | Head Size W145 × 134mm  
Thickness Kiso Hinoki 10.5mm



MADE IN KOREA

USD 342.00



#### KIM TAEK SOO PRIME

Blade Size W255 × 134mm | Head Size W145 × 134mm  
Thickness Kiso Hinoki 10.5mm



MADE IN KOREA

USD 225.00



## Approved & tested by KTS and Professional players



### KTS SHAKEHAND SERIES

The KTS Exclusive & Premium series offers the professional blades made using TMOUNT's outstanding processing technology and manufacturing system. Coach Taek-Soo Kim has undergone numerous test procedures to find the right configuration and balance to maximize blades performance.

#### Features of the KTS Shakehand Series

- Uses plywood tested by coach Taek-Soo Kim
- Outstanding symmetry, leveling, and center of gravity using a cutting-edge processing device
- Outstanding durability by processing specially developed surface nano-coating
- Excellent quality of manufacturing system

#### KTS BLADES Purchase Information

Order online at [ttmount.com](http://ttmount.com)

- TFACTORY KOREA products begin manufacturing at the time of order receipt, so it may take up to 30 days.
- TFACTORY CHINA products start delivery immediately at the time of payment.



#### KTS CORE ALC

##### BLADE CONSTRUCTION

Plies 5W+2Core AL Carbon | Thickness 5.9mm | Weight Avg. 86g | Speed OFF-  
Head Size W150 × H157mm | Grip Size FLW34 × H100mm STW28 × H100mm

Professional blade made for accurate control and excellent stability with core AL Carbon innerfiber 7ply structure

MADE IN KOREA USD 225.00



#### KTS 760

##### BLADE CONSTRUCTION

Plies 5W+2Core AL Carbon | Thickness 5.7mm | Weight Avg. 86g | Speed OFF+  
Head Size W150 × H157mm | Grip Size FLW34 × H100mm STW28 × H100mm

Forms strong drive and sharp attack at moment of impact with Core AL Carbon outerfiber 7ply structure

MADE IN CHINA USD 144.00  
MADE IN KOREA USD 150.00



#### KTS 920

##### BLADE CONSTRUCTION

Plies 5W+2Core ZL Carbon | Thickness 5.6mm | Weight Avg. 86g | Speed OFF+  
Head Size W150 × H157mm | Grip Size FLW34 × H100mm STW28 × H100mm

Blade with strong impact, wide swing spot, and excellent speed based on Core ZL Carbon outerfiber 7ply structure

MADE IN CHINA USD 171.00  
MADE IN KOREA USD 179.00



#### KTS 740

##### BLADE CONSTRUCTION

Plies 5W+2Core AL Carbon | Thickness 5.7mm | Weight Avg. 86g | Speed OFF  
Head Size W150 × H157mm | Grip Size FLW34 × H100mm STW28 × H100mm

All-round style blade with precise attack base on Core AL Carbon outerfiber 7ply structure

MADE IN CHINA USD 148.50  
MADE IN KOREA USD 155.00



#### KTS 570

##### BLADE CONSTRUCTION

Plies 5W+2Core A Carbon | Thickness 5.9mm | Weight Avg. 86g | Speed OFF-  
Head Size W150 × H157mm | Grip Size FLW34 × H100mm STW28 × H100mm

Professional blade with clear sounds, optimized vibration based on Core A Carbon innerfiber 7ply structure

MADE IN CHINA USD 148.50  
MADE IN KOREA USD 155.00



Textured high-elasticity carbon fiber material with weighty hit sensitivity and high repulsive force



Special material featuring outstanding speed and soft hitting sensitivity by texturizing aramid fiber and high-elasticity carbon fiber



Core ZLC special material providing high performance along with top quality elasticity and intensity while having light weight compared to carbon fiber



Core ALC special material featuring accurate control and outstanding stability by texturizing arylate and high-elasticity carbon fiber



## STARDUST BLADE SERIES

TMOUNT Co., Ltd. is the first material brand partner with SWAROVSKI.

Cherish the brand value and dignity based on design products made using 100% genuine SWAROVSKI crystal.

### Check for the official mark seal guaranteeing use of genuine SWAROVSKI crystal.

After its establishment in 1895, the crystal processing technology by Daniel Swarovski has contributed to today's highest quality crystal. His relentless passion for innovation and design has contributed to making SWAROVSKI the world's first-class jewelry brand today. Today, Swarovski is succeeding its heritage, providing special daily styles for customers around the world.

It has an online certification program provided by SWAROVSKI to material brand partners in the world to certify genuine products. Enter the 16-digit code at [crystals-from-swarovski.com](http://crystals-from-swarovski.com) to verify product authenticity.

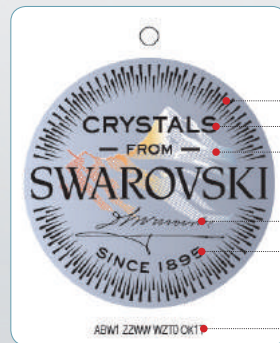

- "Crown" graphic
- Material brand: Crystals from Swarovski
- Tyrolean Mountain hologram
- Signature of founder: Daniel Swarovski
- Founding year
- Track system using the unique identifying code composed of combination of alphabet and numbers

## STARDUST BLADE SERIES

Differentiated features; 5 merits for selection

- Made with 100% genuine SWAROVSKI crystal
- Plywood material tested by coach Taek-Soo Kim
- 3D modular grip type (Patent Pending 10-2020-0063410)
- Outstanding symmetry, flatness, and balance of weight using a cutting-edge processing device
- Guaranteed excellent quality of manufacturing system



## STARDUST GIFT SELECTION

### Blade gift selection completed using attractive SWAROVSKI crystal

Deliver your precious feelings with a sensible special gift for your beloved partner, family, or friend.

The STARDUST gift selection is sent by packing in a high-class signature package.



				
STARDUST GIFT SELECTION <b>SILVER NIGHT</b>	STARDUST GIFT SELECTION <b>SAPPHIRE BLUE</b>	STARDUST GIFT SELECTION <b>SKULL BLUE</b>	STARDUST GIFT SELECTION <b>SKULL BLACK</b>	STARDUST GIFT SELECTION <b>CRYSTAL WHITE</b>
USD 195.00	USD 177.00	USD 177.00	USD 204.00	USD 357.00





STARDUST SILVER NIGHT

**BLADE CONSTRUCTION**  
Plies 3W+2Core X Carbon | Thickness 6.8mm | Weight Avg. 86g | Speed OFF  
Head Size W150 × H157mm | Grip Size FL W34 × H100mm ST W28 × H100mm

Strong drive of Kiso Hinoki with carbon fiber

MADE IN KOREA

USD 180.00



STARDUST SAPPHIRE BLUE

**BLADE CONSTRUCTION**  
Plies 3W+2Core X Carbon | Thickness 6.7mm | Weight Avg. 86g | Speed OFF  
Head Size W150 × H157mm | Grip Size FL W34 × H100mm ST W28 × H100mm

Complete balance between Kiso Hinoki with carbon fiber

MADE IN KOREA

USD 162.00



STARDUST SKULL BLUE

**BLADE CONSTRUCTION**  
Plies 3W+2Core AL Carbon | Thickness 5.7mm | Weight Avg. 86g | Speed OFF+  
Head Size W150 × H157mm | Grip Size FL W34 × H100mm ST W28 × H100mm

Stable control and strong attack for professional

MADE IN KOREA

USD 162.00



STARDUST SKULL BLACK

**BLADE CONSTRUCTION**  
Plies 3W+2Core ZL Carbon | Thickness 5.6mm | Weight Avg. 86g | Speed OFF+  
Head Size W150 × H157mm | Grip Size FL W34 × H100mm ST W28 × H100mm

Professional power blade with strong impact

MADE IN KOREA

USD 189.00



STARDUST CRYSTAL WHITE(JP)

**BLADE CONSTRUCTION**  
Blade Size W255 × 134mm | Head Size W145 × 134mm | Thickness Kiso hinoki 10.5mm

Penholder complete with Kiso Hinoki and SWAROVSKI crystal

MADE IN KOREA

USD 342.00

TCORE AI PENHOLDER SERIES

- Selective manufacturing by Kiso Hinoki, where wood density is strong, soft vibration, and hit feeling is excellent for each grade
- Penholder power fueled by premium mono-ply, 10.5mm thickness Kiso Hinoki
- Kiso Hinoki performance is maximized with selective wood and 3D touch precision processing
- Blade made using natural drying minimizes deformation and distortion
- Guaranteed reliable manufacturing management and excellent quality based on manufacturing made in Korea

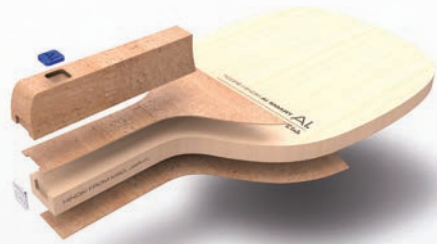

AI.

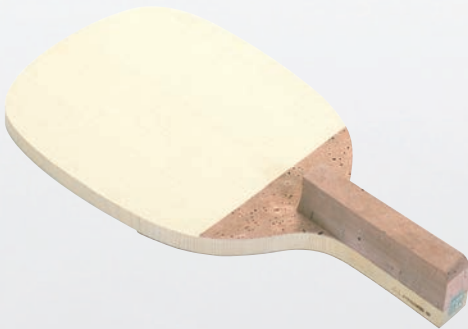

Ai PRIME S

**BLADE CONSTRUCTION**  
Blade Size W255 × 134mm | Head Size W145 × 134mm | Thickness Kiso hinoki 10.5mm

Supreme Kiso hinoki Penholder, special made  
Penholder power fueled by premium mono-ply, 10.5mm thickness Kiso Hinoki

MADE IN KOREA

N/A

AI.



Ai PRIME

**BLADE CONSTRUCTION**  
Blade Size W255 × 134mm | Head Size W145 × 134mm | Thickness Kiso hinoki 10.5mm

Penholder power fueled by premium mono-ply, 10.5mm thickness Kiso Hinoki

MADE IN KOREA

N/A

AI.



Ai PLUS

**BLADE CONSTRUCTION**  
Blade Size W255 × 134mm | Head Size W145 × 134mm | Thickness Kiso hinoki 10.5mm

Penholder power fueled by premium mono-ply, 10.5mm thickness Kiso Hinoki

MADE IN KOREA

N/A

AI.



Ai SMART

**BLADE CONSTRUCTION**  
Blade Size W255 × 134mm | Head Size W145 × 134mm | Thickness Kiso hinoki 10.5mm

Penholder power fueled by premium mono-ply, 10.5mm thickness Kiso Hinoki

MADE IN KOREA

N/A





APEX

**BLADE CONSTRUCTION**  
Plies 3W+2Carbon fiber | Thickness 7.0mm | Weight Avg. 86g | Speed OFF  
Head Size W150 × H157mm | Grip Size FL W34 × H100mm ST W28 × H100mm

NGINEERED BLADE Series  
Perfect power play with hinoki carbon blade

MADE IN CHINA

USD 126.00



ROGUE

**BLADE CONSTRUCTION**  
Plies 3W+2Carbon fiber | Thickness 6.9mm | Weight Avg. 86g | Speed OFF  
Head Size W150 × H157mm | Grip Size FL W34 × H100mm ST W28 × H100mm

NGINEERED BLADE Series  
Perfect power play with hinoki carbon blade

MADE IN CHINA

USD 121.50



DRAKEN

**BLADE CONSTRUCTION**  
Plies 5PLY PUREWOOD | Thickness 6.4mm | Weight Avg. 86g | Speed OFF  
Head Size W150 × H157mm | Grip Size FL W34 × H100mm ST W28 × H100mm

NGINEERED BLADE Series  
Accurate feel and stable defense, 5ply purewood

MADE IN CHINA

USD 50.00



SPITFIRE

**BLADE CONSTRUCTION**  
Plies 5PLY PUREWOOD | Thickness 6.4mm | Weight Avg. 86g | Speed OFF  
Head Size W150 × H157mm | Grip Size FL W34 × H100mm ST W28 × H100mm

NGINEERED BLADE Series  
Accurate feel and stable defense, 5ply purewood

MADE IN CHINA

USD 50.00



QUAKE

**BLADE CONSTRUCTION**  
Plies 5W+2Carbon fiber | Thickness 6.0mm | Weight Avg. 82g | Speed OFF  
Head Size W150 × H157mm | Grip Size FL W34 × H100mm ST W28 × H100mm

NGINEERED BLADE Series  
Offensive 5+2 carbon fiber blade

MADE IN CHINA

USD 72.00



HELLCAT

**BLADE CONSTRUCTION**  
Plies 5W+2Carbon fiber | Thickness 6.0mm | Weight Avg. 82g | Speed OFF  
Head Size W150 × H157mm | Grip Size FL W34 × H100mm ST W28 × H100mm

NGINEERED BLADE Series  
Offensive 5+2 carbon fiber blade

MADE IN CHINA

USD 72.00



TAKE 5S

**BLADE CONSTRUCTION**  
Plies 5W+2Carbon fiber | Thickness 6.0mm | Weight Avg. 82g | Speed OFF  
Head Size W150 × H157mm | Grip Size FL W34 × H100mm ST W28 × H100mm

NGINEERED BLADE Series  
Carbon fiber blade with excellent speedy attack

MADE IN CHINA

USD 72.00



CROSSFIRE

**BLADE CONSTRUCTION**  
Plies 5W+2Carbon fiber | Thickness 6.0mm | Weight Avg. 82g | Speed OFF  
Head Size W150 × H157mm | Grip Size FL W34 × H100mm ST W28 × H100mm

NGINEERED BLADE Series  
Carbon fiber blade with excellent speedy attack

MADE IN CHINA

USD 81.00



TAKE 5D

**BLADE CONSTRUCTION**  
Plies 5W+2Carbon fiber | Thickness 6.4mm | Weight Avg. 78g | Speed OFF  
Head Size W150 × H157mm | Grip Size FL W34 × H100mm ST W28 × H100mm

NGINEERED BLADE Series  
Powerful drive, Offensive 5+2 carbon fiber blade

MADE IN CHINA

USD 81.00



ZENIT

**BLADE CONSTRUCTION**  
Plies 5W+2Carbon fiber | Thickness 6.4mm | Weight Avg. 78g | Speed OFF  
Head Size W150 × H157mm | Grip Size FL W34 × H100mm ST W28 × H100mm

NGINEERED BLADE Series  
Powerful drive, Offensive 5+2 carbon fiber blade

MADE IN CHINA

N/A



## South Korea's only table tennis top manufacturer

The table tennis top is the most important part of a table tennis table in order to determine its quality.

TMOLUNT is highly experienced in woods, coatings, and accumulated know-how such as table tennis design, manufacturing and chemical materials. Because of our valuable experience, we were able to register for patent on table tops featuring LPM technology.

Advancements in manufacturing as well as ITTF certifications have enabled us to become one of the best OEM table tennis brands in the world, known for our high-quality equipment.

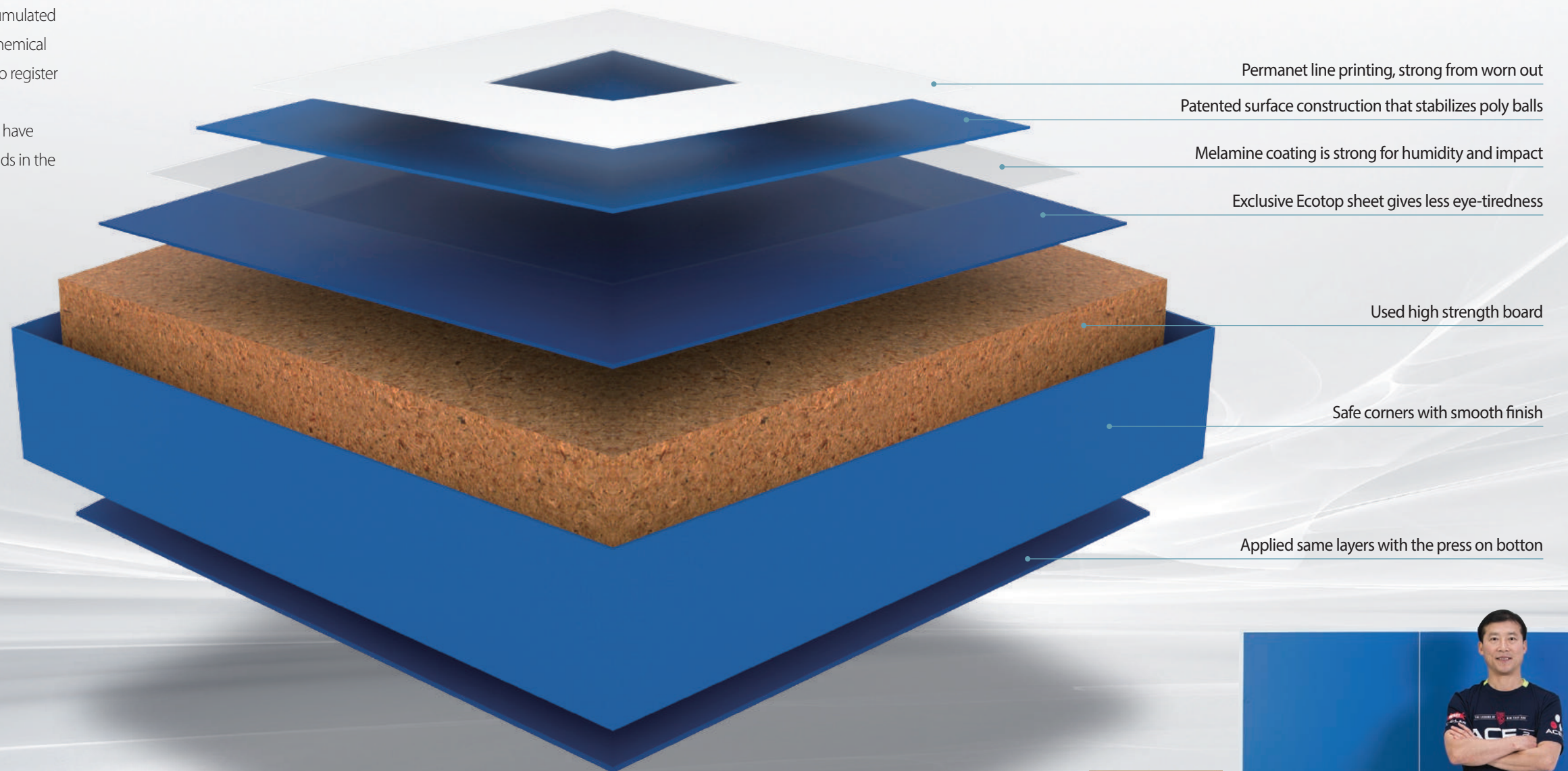

### Major Manufacturing Process of ECOTOP Table Tennis Table

The only company specializing in manufacturing table tennis tables in South Korea. its purpose is to produce high-quality table tennis tables based on an efficient work system.

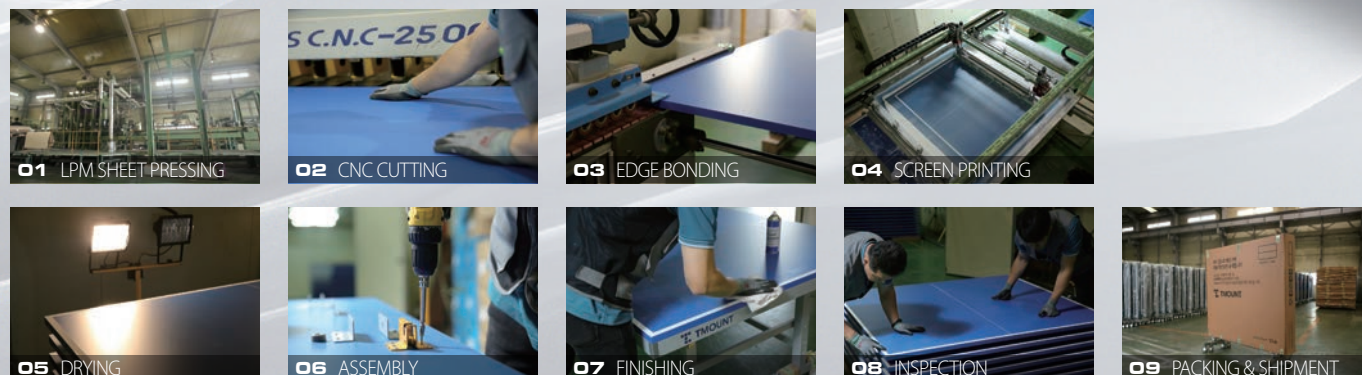

Patent No. 10-1587044







X7

TOP 25mm | FRAME 60×20mm  
CASTER T5"B-4 | WEIGHT 125kg

For professional  
Used 25mm high strength board, ITTF Standard Bound

MADE IN KOREA

N/A

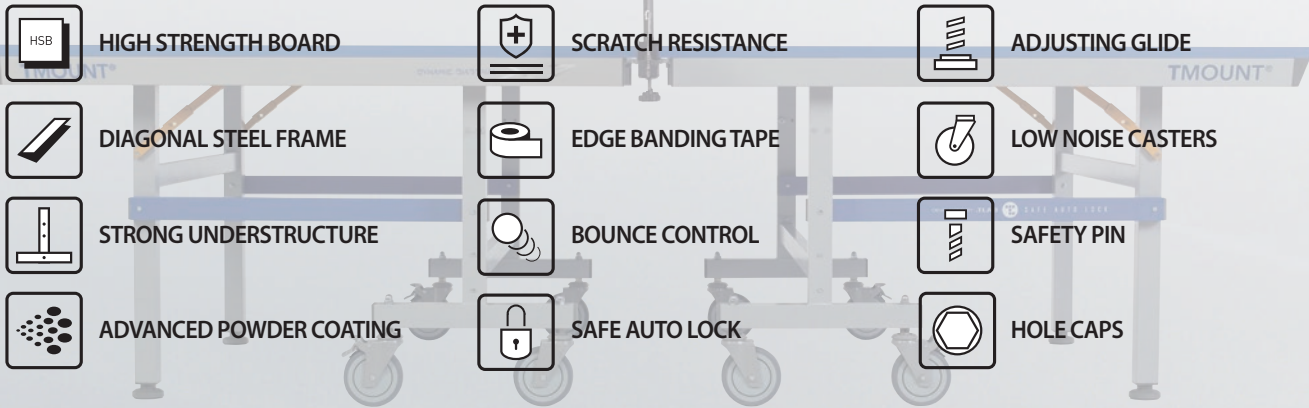

ECOTOP ACE

TOP 25mm | FRAME 60×20mm  
CASTER T5"B-4 | WEIGHT 125kg

ITTF Approved, For the official games  
Used 25mm high strength board, ITTF Standard Bound

MADE IN KOREA

USD 1170.00



ECOTOP ADVANCE

TOP 25mm | FRAME 60×20mm  
CASTER S4"B-4 | WEIGHT 115kg

For professional  
Used 25mm high strength board

MADE IN KOREA

N/A



ECOTOP CLUB

TOP 25mm | FRAME 60×20mm  
CASTER S4"B-4 | WEIGHT 110kg

For the clubs  
Used 25mm high strength board

MADE IN KOREA

N/A



ECOTOP LOVE

TOP 25mm | FRAME 40×20mm  
CASTER S4"B-4 | WEIGHT 110kg

For the clubs  
Used 25mm high strength board

MADE IN KOREA

N/A



ECOTOP SMART

TOP 22mm | FRAME 40×20mm  
CASTER T3"B-4 | WEIGHT 100kg

For the small groups  
Entry-level table tennis table

MADE IN KOREA

N/A



ECOTOP SMART i

TOP 22mm | FRAME 40×20mm  
CASTER T3"B-4 | WEIGHT 100kg

For the small groups  
Entry-level table tennis table

MADE IN KOREA

USD 522.00

ECOTOP SPECIFICATIONS

MODEL	TOP	FRAME	CASTER	WEIGHT	USE
X7	25mm	60×20mm	T5"B-4	125kg	Professional
ECOTOP ACE (ITTF Approved)	25mm	60×20mm	T5"B-4	125kg	Professional
ECOTOP ADVANCE	25mm	60×20mm	S4"B-4	115kg	Professional
ECOTOP CLUB	25mm	60×20mm	S4"B-4	110kg	Clubs
ECOTOP LOVE	25mm	60×20mm	S4"B-4	110kg	Clubs
ECOTOP SMART	22mm	40×20mm	T3"B-4	100kg	Small groups
ECOTOP SMART i	22mm	40×20mm	T3"B-4	100kg	Small groups



# .TBOT KTS PRO

Table tennis training machine with LCD display, programmable and multifuntional

- **MODE** Fixed/Direction/Random
- **SPIN** 9 different spin
- **ANGLE** 360° Turn/Multifuntional
- **BALL** 40mm+(standards)
- **FREQUENCY** 25~95 Balls per minute
- **DIMENSION** 97×55×41cm
- **WEIGHT** 11kg



# .TBOT ACE

Table tennis training machine with LCD display  
Easy to use, display practice posture and the ball position on the LCD screen

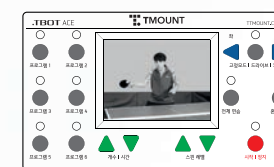

- **MODE** Fixed/Direction/Random
- **SPIN** 9 different spin
- **ANGLE** 360° Turn/Multifuntional
- **BALL** 40mm+(standards)
- **FREQUENCY** 25~95 Balls per minute
- **DIMENSION** 97×55×41cm
- **WEIGHT** 11kg







PN900

SUPPORT 22×25×4.3cm | NETS 175×15cm



ITTF APPROVED

N/A



PN700

SUPPORT 22×26×3.7cm | NETS 180×13cm

For the clubs

N/A



PN500

SUPPORT 21.5×27×2.2cm | NETS 180×13cm

For the clubs

N/A



TBALL ACE 40+(3Star)

ABS Plastic ball(100pcs)

Durable ABS plastic  
seam ball, constant and  
regular bound

USD 67.50



TBALL ACE 40+(2Star)

ABS Plastic ball(100pcs)

Durable ABS plastic  
seam ball, excellent cost-effectiveness

USD 40.50



TBALL ACE 40+(3Star)

ABS Plastic ball(12pcs)

Durable ABS plastic  
seam ball, constant and  
regular bound

USD 9.00



## TMOUNT PROFEEL Table tennis bats

Suitable for beginners and for recreational use with economical package (includes 4 table tennis balls)



PROFEEL R77 Shakehand

3+2 ply carbon table tennis bat with supreme cost-effectiveness  
in the same grade

USD 54.00

PROFEEL R33 Shakehand

PUREWOOD 5PLY TABLE TENNIS BAT

USD 27.00



PROFEEL R1 1 Shakehand

2 table tennis bats in reasonable price range

USD 30.50



PROFEEL G10 Penholder

Easy-to-handle 9.0 mm thickness of plywood penholder

USD 27.00



PROTOUCH M Penholder

Strong drive with upper-level spruce 9.5-mm monopoly

USD 27.00



### RUBBER TECHNOLOGY



POWERHEX

A hexagonal-shaped pimple structure with enhanced  
friction and speed



SPIN EFFECT

Optimal spin effect and stable play



TENSION EFFECT

High Tension Rubber with high density 2.0mm sponge



OPTIMIZED TRAJECTORY

Optimized drive trajectory-oriented rubber

### BLADE TECHNOLOGY



3D TOUCH

High precision 3D touch cutting, offer uniform dimensions



ERGO FIT

Ergonomic grip for grip feeling and increased attack



ENERGY BLADE

Racket with enhanced speed and control through blade  
composition



LIGHT WEIGHT

Powerful and lightweight rackets



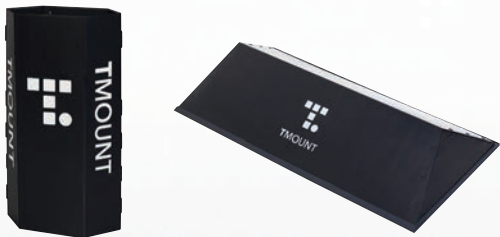

TOWEL BOX

SIZE 44×26×88cm | MATERIAL Plastic  
Easy installation, durable plastic box

N/A

TBLOCK

SIZE 125×25×65cm | MATERIAL Plastic  
Easy installation, durable plastic box

N/A



TSKIRTS

SIZE 195×120cm | MATERIAL Plastic, Lyrex

Table tennis table skirts  
Easy to assemble with velcro  
Durable Lyrex fabric and plastic

N/A

TN1850

SIZE 185×174×50cm | MATERIAL Steel, Mesh

Durable powder coated steel frame

N/A



Nets with Velcro  
Easy to assemble with velcro



Fixed caster  
Safe and easy to move

TSTAND

SIZE 60×75×60cm | MATERIAL Steel

For scoreboard stand  
Durable powder coated steel frame

N/A



Tray  
48.5×16.5cm(Inner 15cm)



Fixed caster  
Safe and easy to move



TF1750

SIZE 275×75cm | Steel frame, Blue cover  
MATERIAL Steel, Nylon | COVER COLOR Blue

Table tennis fence(movable)

N/A



TF2330

SIZE 233×70cm | Steel frame, Blue cover  
MATERIAL Steel, Nylon | COVER COLOR Blue

Table tennis fence(fixed)

N/A



TBALL CATCHER

Balls collector

SIZE Maximum 110cm

N/A

TRC HARD CASE

Durable ABS racket case

SIZE 295×185×55mm  
COLOR Black, Blue, Orange

USD 27.00



RACKET CASE

Soft racket case with balls pocket

SIZE 295×185×55mm  
COLOR Black, Blue, Orange

N/A

TSOCKS

Table tennis socks

Men's  
SIZE 250~280mm | COLOR Black embroidery  
Women's  
SIZE 230~250mm | COLOR Mint embroidery

N/A

TCORE EDGE TAPE

Racket side protection tape

SIZE Total length 25m×Width 100mm

N/A



TSCORE 35

SIZE 48×30×12.5cm  
5 Set 35 Points Multi-Scoreboard

N/A



TSCORE 21

SIZE 42×24×11cm  
5 Set 21 Points Club Scoreboard

N/A



- Useful for various sports
- Storage in solid carton box
- Plastic rings for easy handling
- High quality printed pvc cards
- The bottom of the scoreboard is attached with a magnet





**TMOUNT CO., LTD.**  
Address: W-1009, SKV1 center, 11, Dansan-ro 41-gil, Yeongdeungpo-gu, Seoul, KOREA  
Overseas Sales Manager : Bruce kim +82 10 4287 8387 / bruce@ttmount.com  
Email: [tmount@ttmount.com](mailto:tmount@ttmount.com)  
Website: [ttmount.com](http://ttmount.com)